

Harp Renewables CX20 Aerobic Digester

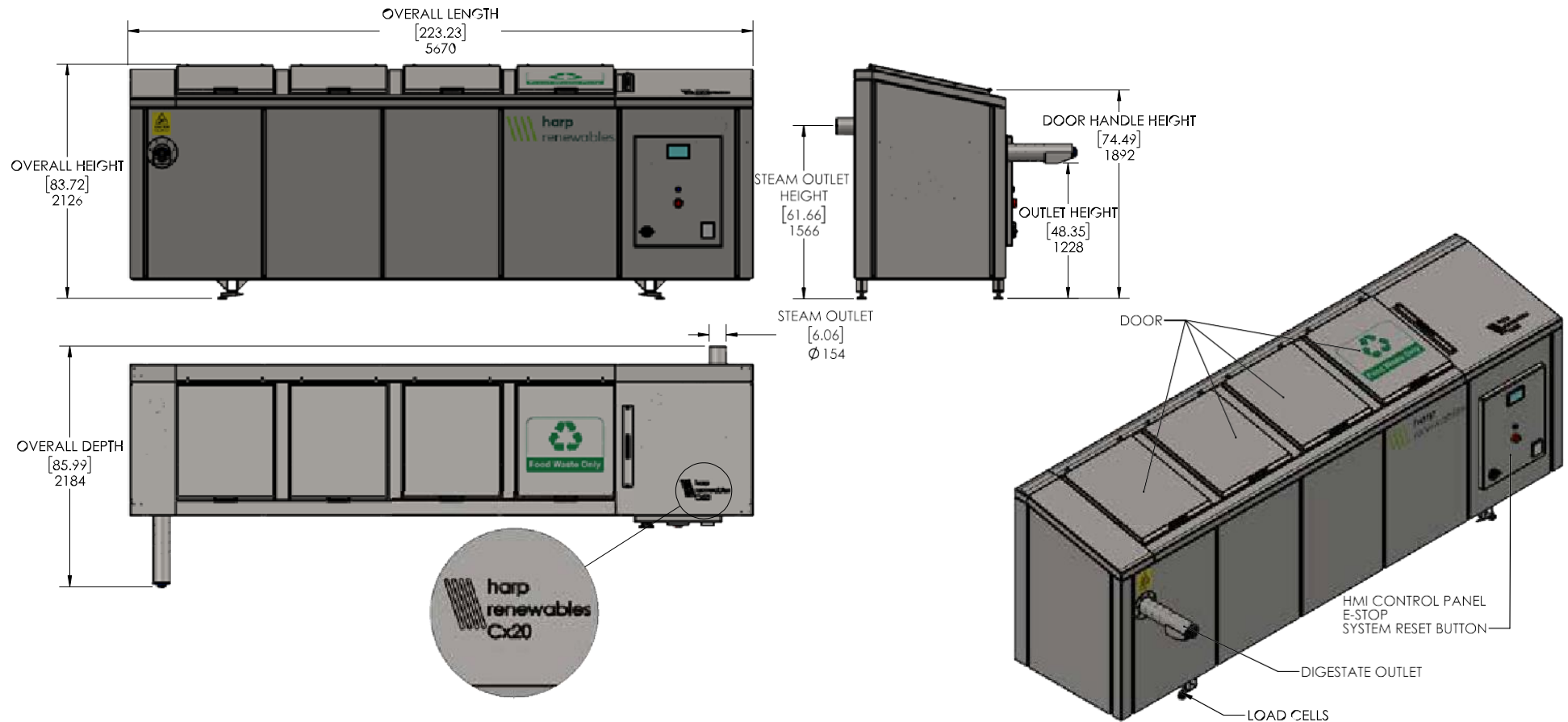

Type:	Accelerated Aerobic Bio-digester
Operation:	Continuous
Process:	Thermophilic (70°C Nominal)
Insulation:	Fully Insulated Shell
Dimensions:	Length: 5670mm (223.23")
	Depth: 2184mm (85.99")
	Height: 2126mm (83.72")
	Height With Door Opened: 3290mm (129.53")

Max Input Capacity:	20,000 Litres /week
Nominal Output Rate:	Approx. 15-30% of input rate
Volume Reduction	85-70% (Approx.)
Motor Power Ratings:	5.5kW / 1.1kW / 1.5kW
Heater Thermal Power:	22kW (total)
Options:	Remote Monitoring & Control (optional), Automated infeed system (Infeed hopper and or shredder), Bin Lifter, Standalone Shredder, Integrated Ozone Unit, Load cells

Electrical Usage (Kwh/year):	35642.88
EU Option Required Power Supply:	3 Phase / 400V / 63A
USA option Required Power Supply:	3 Phase / 480V / 63A

Optional extras may increase the required current. Specifications are subject to change without notice.